

NOTES:

1. ALL BUILDING WORK IS TO COMPLY WITH THE NATIONAL BUILDING REGULATIONS (NBR) AND THE NATIONAL ELECTRICAL REGULATIONS (NER). ANY DIMENSIONS ARE TO BE RELATED TO THE EXTERIOR DIMENSIONS UNLESS OTHERWISE SPECIFIED.

2. ALL WORK IS TO BE DONE IN ACCORDANCE WITH THE SOUTH AFRICAN NATIONAL BUILDING REGULATIONS (NBR) AND THE NATIONAL ELECTRICAL REGULATIONS (NER).

3. ALL WORK IS TO BE DONE IN ACCORDANCE WITH THE SOUTH AFRICAN NATIONAL BUILDING REGULATIONS (NBR) AND THE NATIONAL ELECTRICAL REGULATIONS (NER).

4. ALL WORK IS TO BE DONE IN ACCORDANCE WITH THE SOUTH AFRICAN NATIONAL BUILDING REGULATIONS (NBR) AND THE NATIONAL ELECTRICAL REGULATIONS (NER).

5. ALL WORK IS TO BE DONE IN ACCORDANCE WITH THE SOUTH AFRICAN NATIONAL BUILDING REGULATIONS (NBR) AND THE NATIONAL ELECTRICAL REGULATIONS (NER).

6. ALL WORK IS TO BE DONE IN ACCORDANCE WITH THE SOUTH AFRICAN NATIONAL BUILDING REGULATIONS (NBR) AND THE NATIONAL ELECTRICAL REGULATIONS (NER).

7. ALL WORK IS TO BE DONE IN ACCORDANCE WITH THE SOUTH AFRICAN NATIONAL BUILDING REGULATIONS (NBR) AND THE NATIONAL ELECTRICAL REGULATIONS (NER).

8. ALL WORK IS TO BE DONE IN ACCORDANCE WITH THE SOUTH AFRICAN NATIONAL BUILDING REGULATIONS (NBR) AND THE NATIONAL ELECTRICAL REGULATIONS (NER).

9. ALL WORK IS TO BE DONE IN ACCORDANCE WITH THE SOUTH AFRICAN NATIONAL BUILDING REGULATIONS (NBR) AND THE NATIONAL ELECTRICAL REGULATIONS (NER).

10. ALL WORK IS TO BE DONE IN ACCORDANCE WITH THE SOUTH AFRICAN NATIONAL BUILDING REGULATIONS (NBR) AND THE NATIONAL ELECTRICAL REGULATIONS (NER).

COVERANCE SCHEDULE

AREA OF EXISTING = 12165 MP
 AREA OF NEW = 25680 MP
 AREA OF EXIST. + NEW = 37845 MP
 TOTAL COVER = 178206 MP = 69%

OWNER: MANIFOLD



CLIENT: BRUNSWICK HOTEL & CONFERENCE CENTRE

PROPOSED

ADDITIONS TO THATCHED LAPA ON HOLDING 2 BARTLETT A. H

DATE: JUN/03

SCALE: 1:100

DRAWING NO: W263/1

NEW AREA = 36346 M2

FLOOR PLAN

NEW AREA = 36346 M2

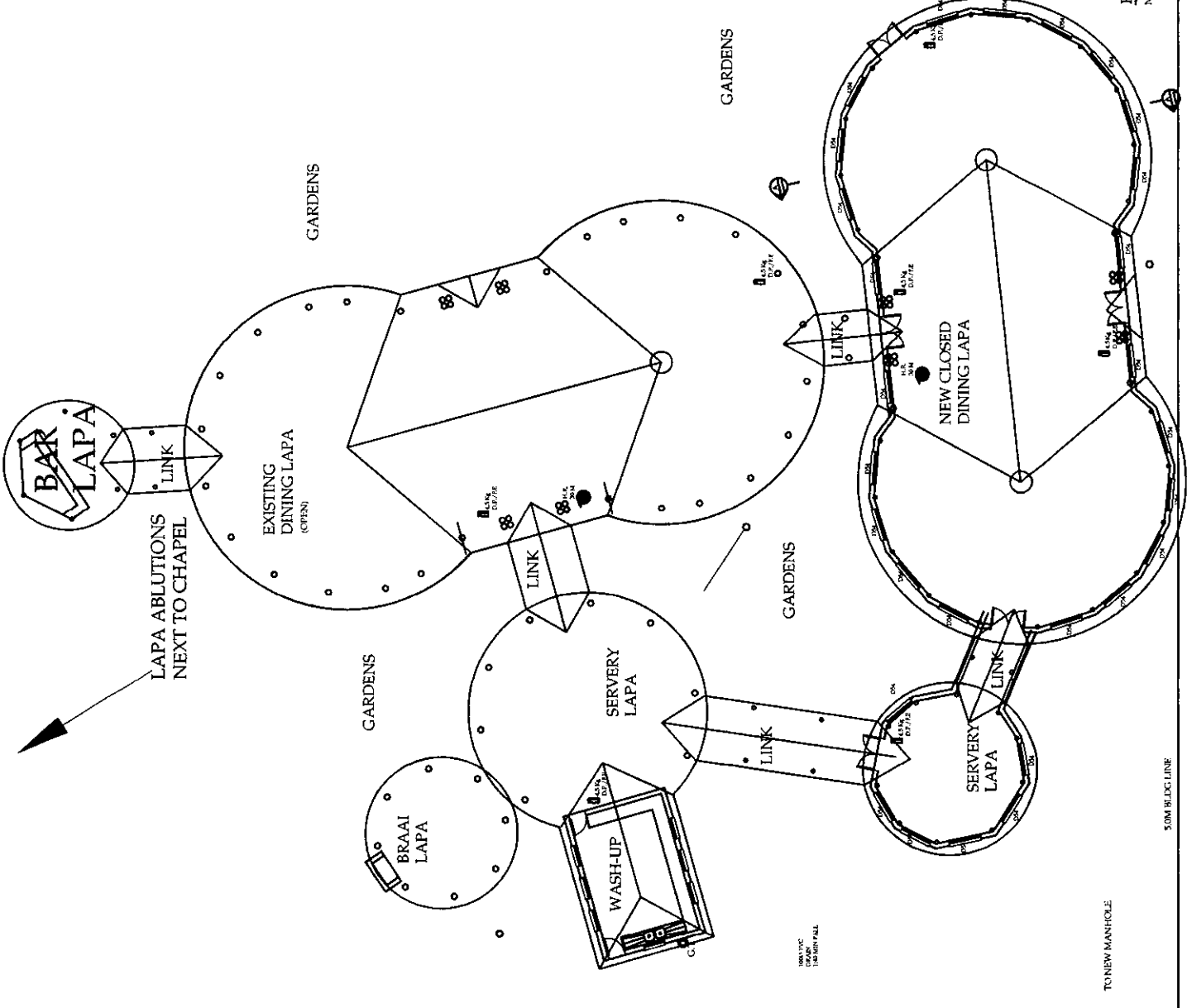

3.0M B.L.C. LINE

TO NEW MANHOLE